



TUNING

Protection, decoration and design

Liquid Gum

Sprayable film

Tuning & Design

with Liquid Gum



easy to
remove

NEW!
400 ml-can
High-yield!

The peel-off sprayable film with grip effect*

The Liquid Gum Spray helps you to create a high-quality coating for protection, decorative or design purposes on your car or a wide range of other objects: and the clever thing is, the spray creates a paint-like protective film that can be peeled off easily at any time. New exciting design possibilities whenever you want.

Liquid Gum in Use:

- Protection and insulation
- Stylistic appearance
- Grip effect
- For car, house, handcraft and hobby

Guaranteed Auto-K quality

- Simple application
- Outstanding adhesion
- Abrasion and stone chip resistant
- Non-slip surface (grip)
- For indoor and outdoor use
- Highly tear resistant when peeling off

* Grip effect: Non-slip function





Cool look for your vehicle – tuning with Liquid Gum

Looks good for as long as you want it to. Liquid Gum is ideal for wheel rims, car bodies and attached parts; colour tuning has never been so flexible.

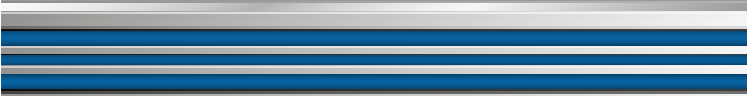
- Reliable protection against stone chip damages
 - Pressure and car washer resistant
 - Can be used on any painted surfaces
 - Non-slip feeling due to grip effect
- 

COLOUR
DESIGN



- Wing mirror in colour design.
- ➔ Washing your car? No problem. Liquid Gum withstands...
- ⬇ ...but can still be peeled off at any time.



The all-round talent for leisure time and lifestyle

Whether in colour or as colourless transparent surface protection out of the spray can, Auto-K Liquid Gum is equally good when visible or invisible. Protect sensitive painted or plastic parts against dirt, mechanical loads, damage, or weathering. Great colours, strong adhesion, reliable protection.



WELL
PROTECTED



↑ Simply detach those parts that are to be sprayed or apply masking tape carefully. Can be used on all smooth, solvent-resistant surfaces.

↓ Can be peeled off at any time without leaving residues.



Colour accents for your home and garden

Looking to upgrade or repair everyday objects? Then opt for Liquid Gum. The colour and protective film makes every object shine like new. And if your tastes change, you can simply remove the film and apply a new one. Try out your creative ideas with Liquid Gum

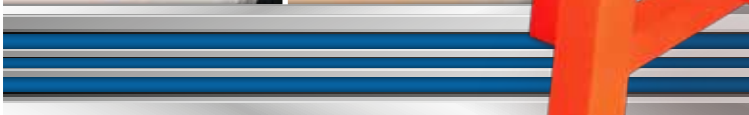
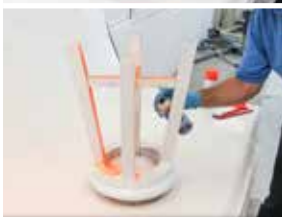



- ↑ Re-design your decorations to match your furnishings.
- ↖ The coating is elastic and fits each object.
- ← Prime first with Liquid Gum white, then apply the neon colour of your choice (the picture here shows neon orange).

Pre-paint wood with a clearcoat to achieve a smooth surface.

**ADAPTS TO
EVERY TREND**

Looking for a new colour design?

Liquid Gum allows you to choose new colours as often as you want: bright neon colours, blue or classic black and white. The choice is yours, because the Auto-K Liquid Gum means you can realise your creative ideas whenever you want. And, if you change your mind, you can simply peel it off without leaving any residues.

Reliable non-slip
surfaces thanks
to Liquid Gum
"Grip"

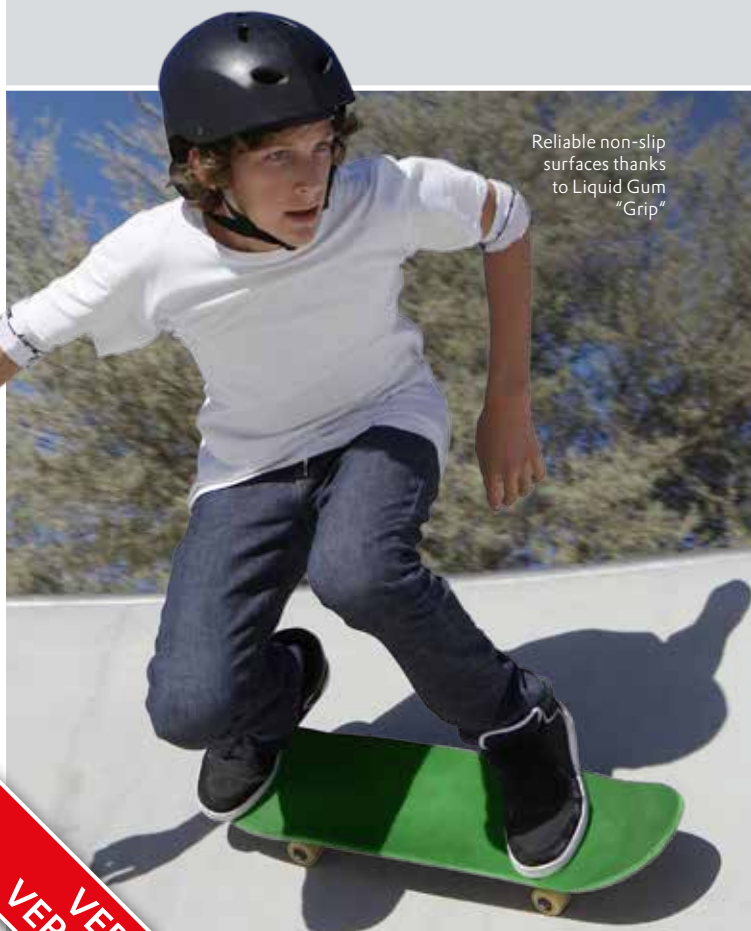

VERY
VERSATILE



Auto-K Liquid Gum is suitable for all smooth, non-absorbent surfaces or glass, and can be removed just as easily. The following pages provide important ideas and tips on how to use the product properly.

Classic colour shades



Colour	black	white	transparent
Art.-No.:	233 250	233 251	233 256

Brilliant / neon colours

A white primer (Liquid Gum white, Art.-No.: 233 251) or a white substrate is required to achieve the glow effect.



Colour	brilliant blue	neon pink	neon green	neon orange
Art.-No.:	233 252	233 253	233 254	233 255

Colours in pictures are not colour binding.
They can deviate for technical print reasons.

Application guide

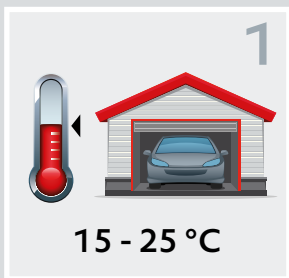

The ideal workplace

Ideally you should work in e.g. an open garage or even outdoors. Avoid wind and direct sunshine. Ideal ambient temperature 15 - 25°C. Do not smoke. Cover immediate surroundings.



Clean the object you want to paint

Surfaces must be resistant to solvents, and should be clean and dry. Only use on smooth non-absorbent surfaces (metal, glass, plastic, painted wood etc.). Seal wooden surfaces first with e.g. a clearcoat.

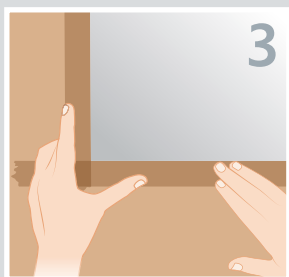

Prepare the object you want to paint

Mask carefully. When coating equipment, ensure that all ventilation slits, openings, switches, keyboards etc. are covered. Detach wheels from vehicles to ensure the wheel rims are coated evenly. Prevent spray mist landing on the brake system.



Prepare/shake the can

After removing the spray lock (lift with a screwdriver), shake the can thoroughly for at least 2 minutes.

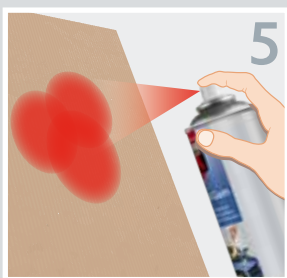

Test spray

Test spray onto cardboard to check the colour shade. Also test spray at an inconspicuous point to check the suitability of the surface (solvent resistant).



Correct use

Hold the can vertically; the correct spray distance is 10 - 20 cm. Always start spraying next to the object and spray quickly and evenly.



Layer structure

Spray about 5 even, closed, thin layers to ensure that an adequate layer of film is created. Observe a flash-off time of 5 - 10 minutes between the separate layers.



Information about coat structure

No full hiding is achieved after 2-3 spray passes because the product acts similar to a stain. Minimum 5 spray passes are required to achieve full hiding as well as the full tearing strength required for the peel-off procedure.

Important: Always remove the masking tape as long as the last layer is still wet; otherwise there is a risk the edges will rupture.



After Painting

Turn the can upside down and spray until the valve is empty to prevent clogging. Wipe off any remaining paint from the spray head.

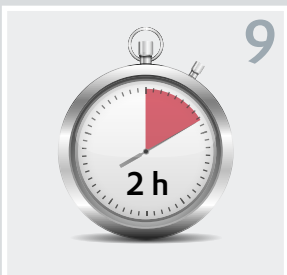

Drying times

The spray film can be removed after approx. 2 hours drying time.

Liquid Gum can be topcoated with Auto-K/belton spray aerosols. Apply max. 3 spray passes. More topcoats make it difficult to peel-off.

Dust dry Dry level 1 acc. to DIN 53150	45 min.
Dry-to-touch / ready for mounting Dry level 3 acc. to DIN 53150	90 min.
Waterproof / rainproof	2 h
Can be removed after	2 h
Can be painted over after	2 h

Attention! Do not use products containing solvents, e.g. degreaser (petroleum benzine).

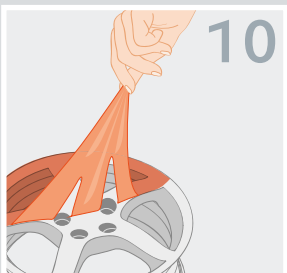

Removal of the spray film

Don't like the colour shade (anymore)? No problem. The spray film can be removed after approx. 2 hours drying time. Using your fingernails, peel the spray film carefully from the edges and then pull off.



Special information for painting Brilliant/neon colour shades:

The surface always needs to be white or primed with white first before applying neon colours (green, orange, pink) and brilliant blue. This ensures that the colours develop their brightness!

We recommend applying 2 coats of Auto-K Liquid Gum white (Art.-No.: 233 251). Then apply the colour shade of your choice.

The number of spray coats has an impact on the colour intensity; The more spray coats there are, the more intensive the colour result.



Application clip



The Auto-K Liquid Gum application video offers valuable advice, tips and tricks to ensure your project is a success. For more information, please visit **www.auto-k.de**



TUNING

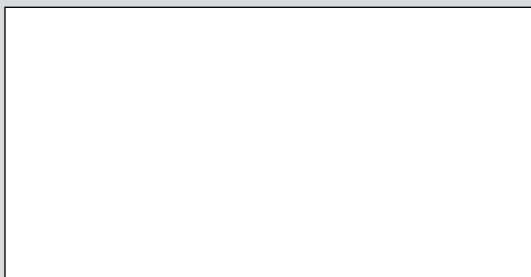

**Auto-K is a brand of
Peter Kwasny GmbH**

Heilbronner Str. 96
D-74831 Gundelsheim
Tel. +49 (0) 62 69 / 95-0
Fax +49 (0) 62 69 / 95 80
info@kwasny.de
www.kwasny.com

Art.-Nr.: 992 299/10.14 Br